



BioMADE

**Bioindustrial Manufacturing
and Design Ecosystem**

BioMADE Launch Week - Education & Workforce Development

April 30, 2021

www.biomade.org

Welcome -

Dr. Tom Tubon

Chief Workforce Development Officer

BioMADE Education & Workforce Development: Strategic Vision

To prepare a robust domestic workforce for manufacturing jobs across the bioindustrial sector.

The Education & Workforce Development approach is focused on the Department of Defense and industry drivers that emphasize community awareness and engagement, product innovation, development, commercialization and national economic security.

BioMADE Education & Workforce Development: Guiding Principles

- Build Awareness of bioindustrial manufacturing careers.
- Preparing the future workforce through innovative educational strategies.
- Support the growth of our current workforce with world-class professional development.



BioMADE Education & Workforce Development

- Industry Engagement
- Academic Engagement
- Alignment of Industry & Academic Equities
- Diversity, Equity, Inclusion & Accessibility
- Coordinated Engagement of the Manufacturing Innovation Institutes
- Institutional Sustainability
- Societal Impacts

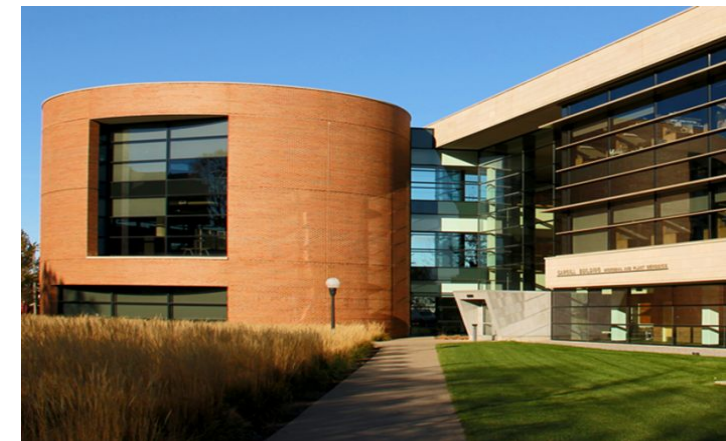
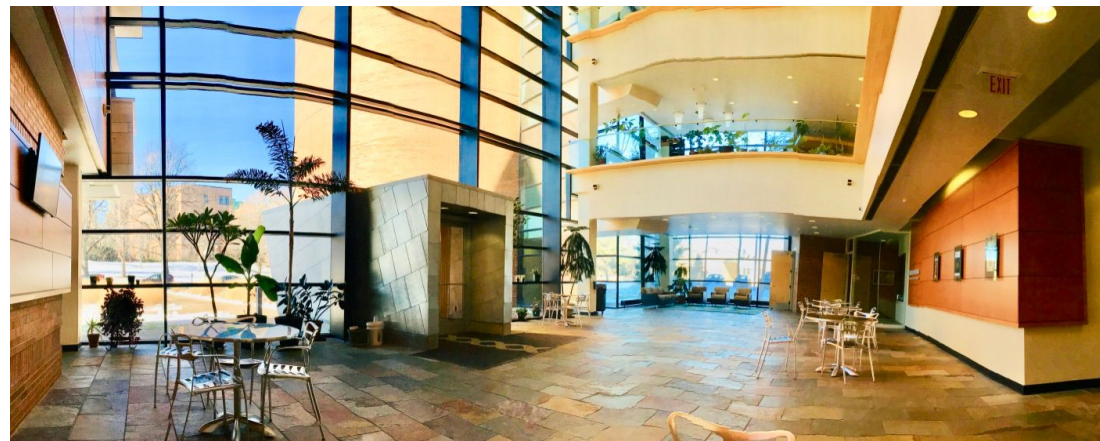

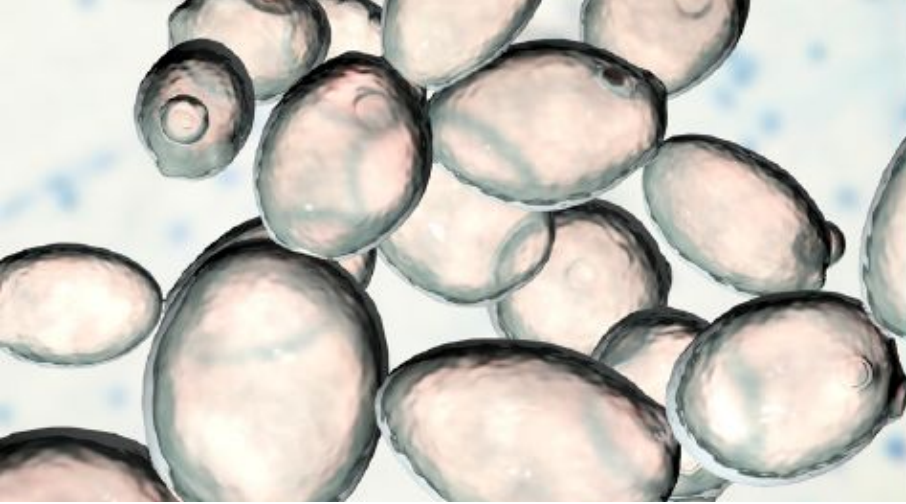

Questions about EWD Programs?

Contact

Tom Tubon, Chief Workforce Development Office
tctubon@biomade.org

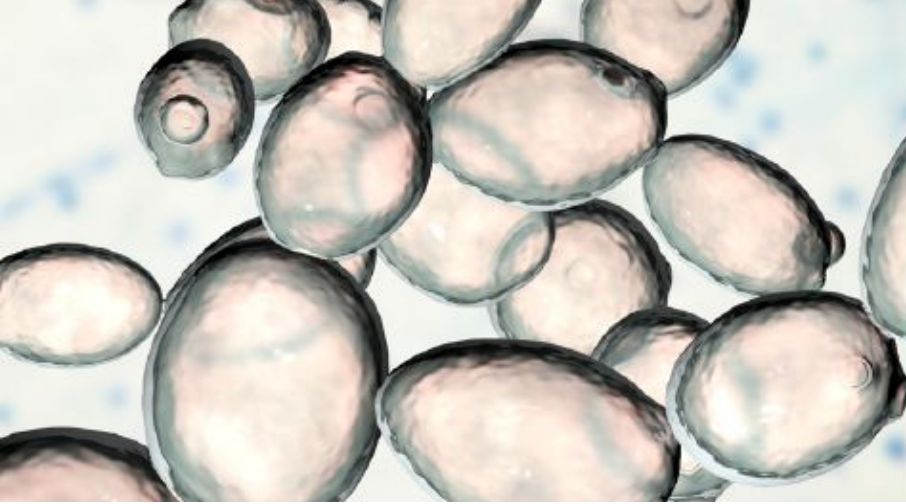

Questions about Membership?

Contact

Laura Vitko, Membership Manager
membership@biomade.org

EWD Open Project Call

Goals for this Session

- Provide an overview of the RFP
- Introduce the application process
- Describe the funding priority areas
- Answer your questions -
please submit your questions in the chat as they arise.

MAIN GOAL - Everyone leaves this session understanding what we're looking for in terms of proposals.

Open Request for Proposals (RFPs): The Basics

What - non-medical biotechnology products and processes to advance the field of bioindustrial manufacturing

Who - **BioMADE members** (as submitting institution)

Funding availability - **\$2,000,000 over 2 years**

Cost share requirement - **1:1 minimum** (see Appendix B of the RFP)

Team Composition

BioMADE was established in response to a call for a **bioindustrial manufacturing innovation institute**. Find one or more industry partners!

Foreign participation - BioMADE, like all of the MIIs, was established to stimulate U.S. manufacturing capabilities. International partners are eligible to participate under some circumstances. Specifics will need to be discussed with a BioMADE program manager.

BioMADE Membership

Lead organizations are required to be members of BioMADE at the time of **full-proposal** submission.

All members of a project team will be required to become BioMADE members in the event of funding.

Vendors and CMOs are exempt from this requirement if they are solely providing service or materials as part of their regular business.

Submissions

- **This is a two-step submission process.** There will be a white paper phase followed by invitations to submit full proposals.
- **White papers are templated and submitted via email** (detailed instructions are in the RFP).
- **White papers are reviewed by BioMADE staff and USG personnel.** Other members will NOT see your proposal.
- **Teams invited to submit full proposals** will be afforded a **one hour meeting** with the BioMADE EWD team to discuss expectations of the project.
- **Full proposals will be 12 pages or fewer.**

Timeline

Key dates for for this Open RFP are as follows:

- **April 22, 2021: BioMADE Open RFP is released**
- **May 28, 2021: White papers are due by 11:59 pm EST.**
- BioMADE will send invitations for Full Proposals to selected teams within a month of the White Paper deadline.
- Full Proposals will be due within a month of notice of selection.

* Additional information will be made available through webinars and/or direct contact with a program manager

Funding Priority Areas

1. Building awareness of opportunities in bioindustrial manufacturing; applicable to pre-career audiences, those at career transitions, and those looking to integrate bio-based processes into their workflows
2. Training the pre-employment workforce to close the skills and competencies gaps; particularly multidisciplinary training efforts
3. Advancing the current workforce to develop skills related to cutting edge technologies or integration of bio-based process into new areas or platforms